

# ADVANTAGE

# SCHEMATICS

## ADVANTAGE™

LAVATORY  
19-161 FAUCET WITH  
POP-UP

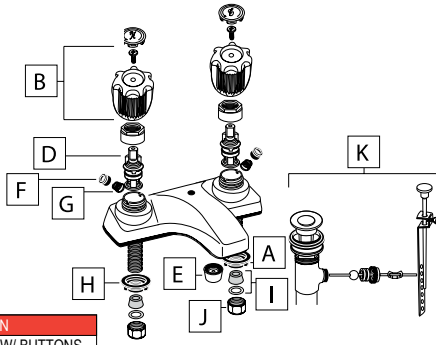

ID.	ITEM #	DESCRIPTION
B	22-637	HANDLE KIT W/ BUTTONS
D	26-637	CARTRIDGE
E	23-244	AERATOR
F	23-433	SEAT
G	23-436	SPRING
H	24-099	LOCKNUT
I	36-116	SUPPLY WASHER & RING
J	24-102	COUPLING NUT
K	11-152	POP-UP ASSEMBLY

## ADVANTAGE™

LAVATORY  
19-361 FAUCET WITH  
POP-UP

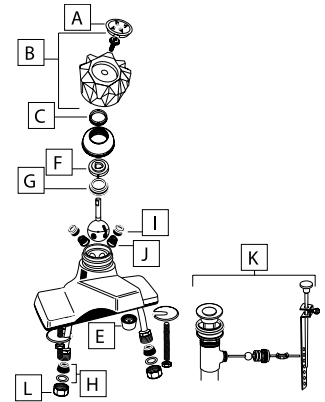

ID.	ITEM #	DESCRIPTION
A	22-078	BUTTON
B	21-215	HANDLE KIT
C	23-603	ADJUSTING RING
E	23-244	AERATOR
F	23-421	CAM
G	23-623	PACKING
H	36-116	SUPPLY WASHER & RING
I	23-433	SEAT
J	23-436	SPRING
K	11-152	POP-UP ASSEMBLY
L	24-102	COUPLING NUT

## ADVANTAGE™

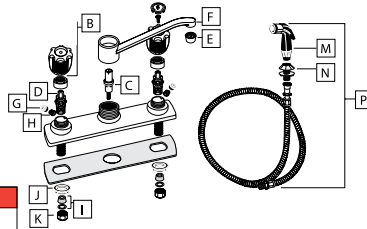

ID.	ITEM #	DESCRIPTION
A	23-306H/C	HOT/COLD BUTTONS
B	22-637	HANDLE KIT
C	23-450	DIVERTER
D	26-437	CARTRIDGE
E	23-244	AERATOR
F	22-713	SPOUT
G	23-433	SEAT
H	23-436	SPRING
I	36-116	SUPPLY WASHER & RING
J	24-099	LOCKNUT
K	24-102	COUPLING NUT
M	23-261	SPRAY HEAD
N	23-258	GUIDE
P	23-260	HOSE & SPRAY COMPLETE

KITCHEN  
19-551 FAUCET WITH SPRAY

## ADVANTAGE™

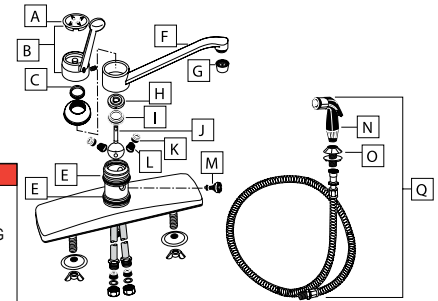

ID.	ITEM #	DESCRIPTION
A	22-078	BUTTON
B	21-278	HANDLE KIT
C	23-603	ADJUSTING RING
E	20-636	O-RING
F	22-711	SPOUT
G	23-244	AERATOR
H	23-421	CAM
I	23-623	PACKING
J	26-331	S.S. BALL
K	23-433	SEAT
L	23-436	SPRING
M	23-172	DIVERTER
N	23-261	SPRAY HEAD
O	23-258	GUIDE
Q	23-260	HOSE & SPRAY

KITCHEN  
19-651 FAUCET WITH SPRAY

## ADVANTAGE™

TUB & SHOWER

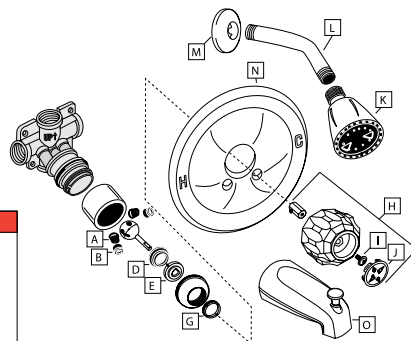

ID.	ITEM #	DESCRIPTION
A	23-436	SPRING
B	23-433	SEAL
D	23-423	PACKING
E	23-421	CAM
G	23-303	ADJUSTING RING
H	21-215	HANDLE ASSEMBLY
I	20-291	SCREW
J	22-078	BUTTON
K	13-113	SHOWER HEAD
L	13-109	SHOWER ARM
M	13-214	FLANGE
N	13-612	ESCUTCHEON
O	13-932	SPOUT

## ADVANTAGE™

LAUNDRY  
17-533 FAUCET

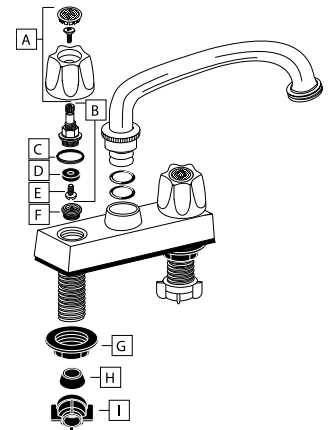

ID.	ITEM #	DESCRIPTION
A	29-700	HOT/COLD HANDLES
B	28-154R	HOT/COLD STEM
C	20-442	CAP GASKET
D	20-731	BIBB WASHER
E	20-248	BIBB SCREW
F	27-340	SEAT
G	24-098	LOCKNUT
H	36-116	SUPPLY WASHER
I	24-099	COUPLING NUT

Notes:

**American KITCHENS**

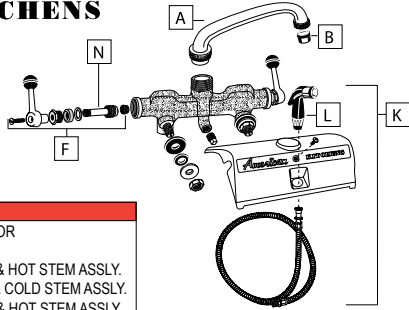

ID	ITEM #	DESCRIPTION
A	15-109	SPOUT WITH AERATOR
B	23-144	AERATOR ONLY
E	23-112H	7 PC. FLAT HANDLE & HOT STEM ASSLY.
E	23-112C	7PC. FLAT HANDLE & COLD STEM ASSLY.
F	23-105H	7 PC. BALL HANDLE & HOT STEM ASSLY.
F	23-105C	7 PC. BALL HANDLE & COLD STEM ASSLY.
K	23-260	HOSE AND SPRAY KIT
L	23-261	SPRAY HEAD ONLY

**For AMERICAN STANDARD**

LAVATORY  
(AND KITCHEN, TUB & SHOWER)

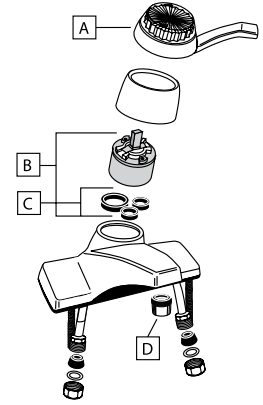

**AQUARIAN**

ID	ITEM #	DESCRIPTION
A	21-454	HOT/COLD HANDLE
B	26-203	HOT/COLD CARTRIDGE
C	21-840	CARTRIDGE SEAL KIT
D	23-144	AERATOR

**For AMERICAN STANDARD**  
LAVATORY (AND KITCHEN)

**COLONY**

ID	ITEM #	DESCRIPTION
A	20-813	HANDLE SCREW
B	29-428	HOT/COLD HANDLES
C	28-140R	RH HOT STEM
D	28-140L	LH COLD STEM
E	20-212	CAP GASKET (O'RING)
F	20-731	BIBB WASHER
G	20-243	BIBB SCREW
H	27-310	SEAT
I	23-144	AERATOR

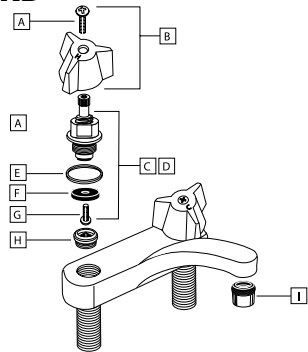

**For AMERICAN STANDARD**  
LAVATORY  
HERITAGE/AQUASEAL  
OR R-SERIES

ID	ITEM #	DESCRIPTION
A	22-016H	HOT INDEX BUTTON
B	22-016C	COLD INDEX BUTTON
C	20-825	HANDLE SCREW
D	29-415	HOT/COLD HANDLES
E	21-516	STEM LOCKNUT
F	28-149R	RH HOT STEM
G	28-149L	LH COLD STEM
J	26-170	WASHER
K	27-380	SEAT
L	27-381	SEAT
M	23-144	AERATOR
N	28-179R	RH HOT STEM
O	28-179L	LH COLD STEM
P	20-442	CAP GASKET
Q	20-732	BIBB WASHER
R	20-241	BIBB SCREW

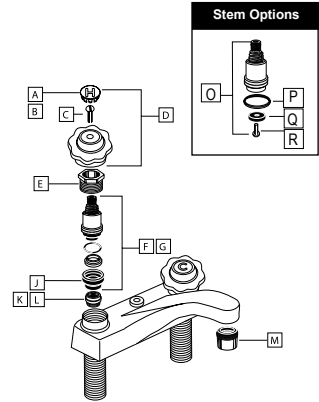

**For AMERICAN STANDARD**  
KITCHEN

**COLONY**

ID	ITEM #	DESCRIPTION
A	20-813	HANDLE SCREW
B	29-463	HOT/COLD HANDLES
E	36-227	FRICTION RING
F	28-130R	RH HOT STEM
G	28-130L	LH COLD STEM
H	20-732	BIBB WASHER
I	20-241	BIBB SCREW
J	27-310	SEAT
K	23-144	AERATOR

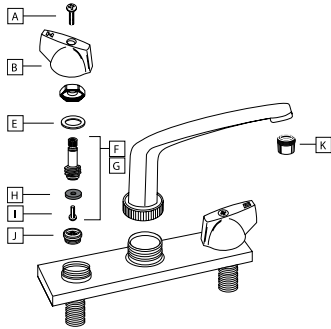

**For AMERICAN STANDARD**  
KITCHEN

**HERITAGE/AQUASEAL**

ID	ITEM #	DESCRIPTION
A	22-016H	HOT BUTTON
B	22-016C	COLD BUTTON
C	20-825	HANDLE SCREW
D	29-416	HOT/COLD HANDLES
E	21-516	STEM LOCKNUT
F	28-149R	RH HOT STEM
G	28-149L	LH COLD STEM
I	26-170	SEAT WASHER
J	27-380	SEAT
K	23-144	AERATOR

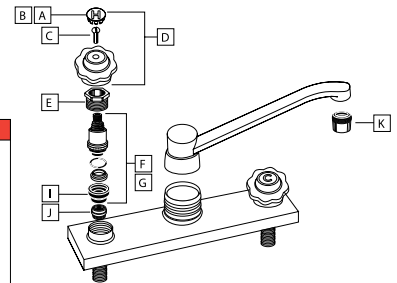

**For AMERICAN STANDARD**  
SHOWER

ID	ITEM #	DESCRIPTION
A	20-819	HANDLE SCREW
B	29-418D	DIVERTER HANDLE
C	29-418	HOT/COLD HANDLES
F	28-929D	DIVERTER STEM
G	28-705R	HOT/COLD STEM
K	20-732	BIBB WASHER
L	20-241	BIBB SCREW
M	27-382	SEAT

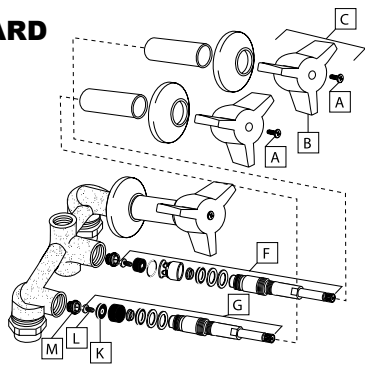

**For AMERICAN STANDARD**  
SHOWER

ID	ITEM #	DESCRIPTION
A	22-016D	DIVERTER INDEX BUTTON
B	20-825	HANDLE SCREW
C	22-016H	HOT INDEX BUTTON
D	22-016C	COLD INDEX BUTTON
E	29-416	HOT/COLD HANDLES
H	21-516	FAUCET LOCKNUT
I	28-726D	DIVERTER STEM
J	20-737	BIBB WASHER
K	20-243	BIBB SCREW
L	27-302	SEAT
M	28-143R	RH HOT STEM
N	28-143L	LH COLD STEM
Q	20-181	WASHER
R	27-536	SEAT
S	28-179R	RH HOT STEM
T	28-179L	LH COLD STEM
U	20-212	O'RING

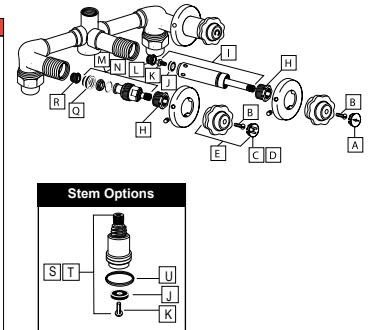

Notes:



**For AMERICAN STANDARD**  
65-412 COMPLETE FLUSH VALVE

**#4 OLD STYLE**

ID.	ITEM #	DESCRIPTION
A	65-401	HOOK
B	65-495	CHAIN
D	65-400	HOOK, CHAIN, GROMMET KIT
E	65-718	FLOAT ASSEMBLY
F	60-106	SEAT DISC
H	65-408	SEAL
K	65-404	NUT & SCREW
M	65-805	PLASTIC SUPPORT LEG
N	65-406	F.H. SCREWS
O	65-407	SEAT
P	65-411	FASTENING LUGS
Q	65-409	BOLT HOLE SEALS
R	65-418	ACTUATING UNIT
S	65-415	SCREW FOR SEAT DISC

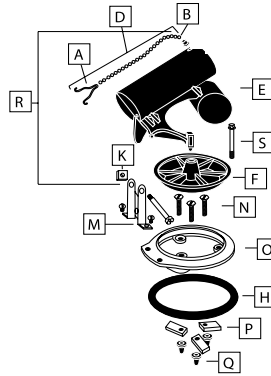

**For AMERICAN STANDARD**  
65-413 COMPLETE FLUSH VALVE

**SERIES 3158**

ID.	ITEM #	DESCRIPTION
A	65-401	HOOK
B	65-495	CHAIN
D	65-400	HOOK, CHAIN, GROMMET KIT
E	65-717	FLOAT ASSEMBLY
F	60-107	SEAT DISC
G	65-410	FLOAT & DISC ASSEMBLY
H	65-713	FLUSH VALVE ONLY
I	63-119	WASHER
J	69-106	LOCKNUT
K	65-413	COMPLETE #5 FLUSH VALVE

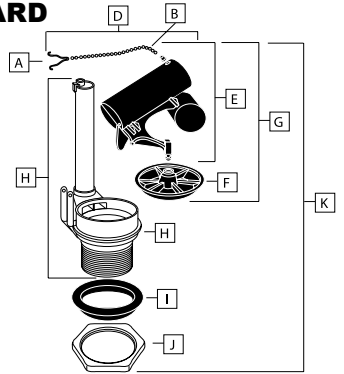

**For AMERICAN STANDARD**  
65-612 COMPLETE FLUSH VALVE

**#4 NEW STYLE**

ID.	ITEM #	DESCRIPTION
A	65-401	HOOK
B	65-495	CHAIN
D	65-400	HOOK, CHAIN, GROMMET KIT
F	60-107	SEAT DISC
G	65-417	FLOAT & DISC ASSEMBLY
H	65-408	SEAL
I	65-411	FASTENING LUGS

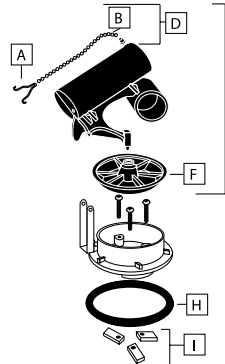

**For BRADLEY-COLE/BRIGGS**  
LAVATORY

**CASCADE/AURORA**

ID.	ITEM #	DESCRIPTION
A	22-071	BUTTON
B	21-471	HOT/COLD HANDLE
C	26-922	CARTRIDGE COMPLETE
D	26-920	KIT WITH STEM
F	23-144	AERATOR
G	20-811	HANDLE SCREW

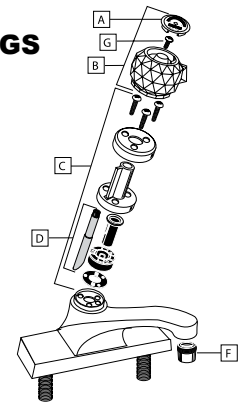

**For CENTRAL**  
LAVATORY (AND KITCHEN)

ID.	ITEM #	DESCRIPTION
A	20-816	HANDLE SCREW
B	29-491	HOT/COLD HANDLES
C	28-040R	HOT STEM
D	28-040L	COLD STEM
E	20-442	CAP GASKET
F	20-732	BIBB WASHER
G	20-241	BIBB SCREW
H	27-354	SEAT
I	23-144	AERATOR
J	28-045R	HOT STEM
K	28-045L	COLD STEM
L	20-442	CAP GASKET

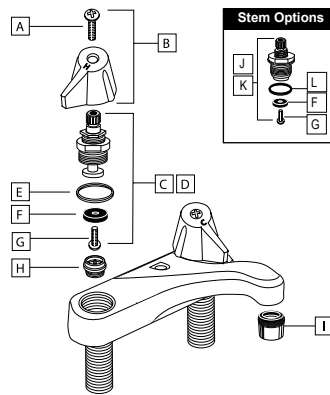

**For CENTRAL**  
SHOWER

ID.	ITEM #	DESCRIPTION
A	20-816	HANDLE SCREW
B	29-493	HOT/COLD HANDLES
C	29-493D	DIVERTER HANDLE
D	23-890	FLANGE
E	23-551	FLANGE NIPPLE
F	28-806D	DIVERTER STEM
G	28-700R	HOT/COLD STEM
H	20-354	DIVERTER WASHER
I	20-430	CAP GASKET
J	20-737	BIBB WASHER
K	20-243	BIBB SCREW
L	27-434	SEAT
M	20-736	BIBB WASHER
N	20-241	BIBB SCREW
O	27-344	SEAT

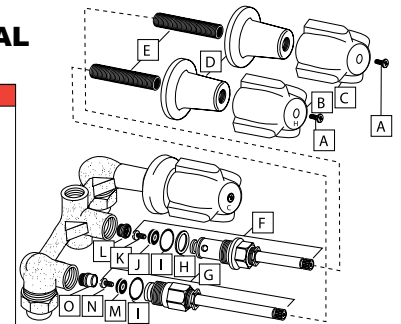

**For CRANE/REPCAL**  
LAVATORY

ID.	ITEM #	DESCRIPTION
A	20-813	HANDLE SCREW
B	29-056	HOT/COLD HANDLES
C	28-425R	HOT STEM
D	28-425L	COLD STEM
E	21-122	WASHER KIT (2EACH)
F	23-144	AERATOR

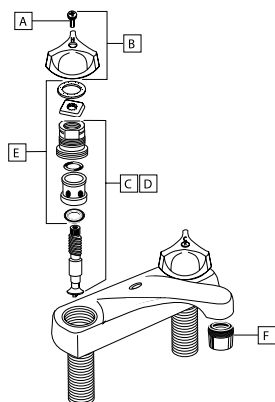

**For CRANE/REPCAL**  
SHOWER

ID.	ITEM #	DESCRIPTION
A	20-813	HANDLE SCREW
B	29-058	HOT/COLD HANDLES
C	29-058D	DIVERTER HANDLE
D	23-268	SLEEVE
E	23-298	FLANGE
F	28-753D	DIVERTER STEM
G	28-752R	HOT/COLD STEM
H	20-624	O'RING
I	20-734	DIVERTER BIBB WASHER
J	20-732	BIBB WASHER
K	20-243	BIBB SCREW
L	27-312	SEAT

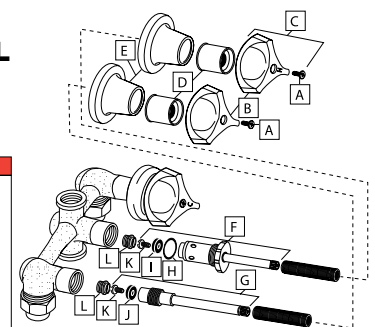

Notes:

**DELTA**  
FAUCET COMPANY  
**GENUINE PARTS**  
LAVATORY

ID.	ITEM #	DESCRIPTION
A	23-308	OLD STYLE HANDLE BUTTON
B	22-241	NEW STYLE HANDLE BUTTON
C	21-129	CAP & RING
D	23-405	CAM & PACKING
E	26-333	S.S. BALL
F	23-400	SEATS & SPRINGS (2 EACH)
G	23-433	SEAT
H	23-436	SPRING
I	21-402	HANDLE KIT
J	24-155	AERATOR

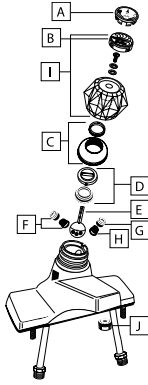

**DELTA**  
FAUCET COMPANY  
**GENUINE PARTS**  
LAVATORY  
(AND KITCHEN)

ID.	ITEM #	DESCRIPTION
A	23-312	HOT/COLD BUTTONS
B	22-538	H/C HANDLE PAIR
C	26-437	HOT OR COLD CARTRIDGE
D	23-400	SEAL KIT
E	23-433	SEAT
F	24-155	AERATOR
G	23-436	SPRING
I	22-536	HOT/COLD HANDLES

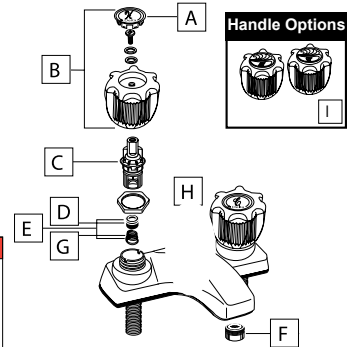

**DELTA**  
FAUCET COMPANY  
**GENUINE PARTS**  
LAVATORY

ID.	ITEM #	DESCRIPTION
A	21-403	SINGLE LEVER HANDLE
B	23-303	ADJUSTING RING
C	21-169	CAP
D	23-421	CAM
E	23-423	PACKING
F	26-331	S.S. BALL
G	23-433	SEAT
H	23-436	SPRING
I	24-155	AERATOR
J	23-400	SEATS & SPRINGS (2 EACH)

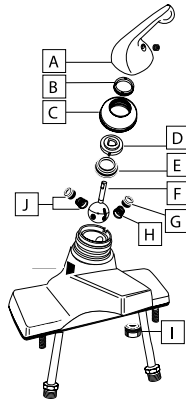

**DELTA**  
FAUCET COMPANY  
**GENUINE PARTS**  
SHOWER

ID.	ITEM #	DESCRIPTION
A	21-403	SINGLE LEVER HANDLE
B	13-408	ESCUTCHEON
C	21-129	CAP & RING
D	23-403	CAM & PACKING
E	26-331	S. S. BALL
F	26-311D	DIVERTER
G	23-400	SEATS & SPRINGS
H	23-433	SEAT
I	23-436	SPRING

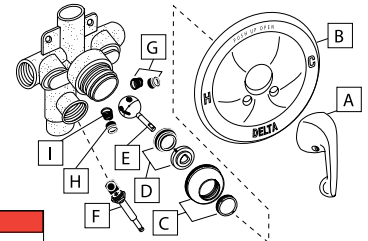

**DELTA**  
FAUCET COMPANY  
**GENUINE PARTS**  
KITCHEN

ID.	ITEM #	DESCRIPTION
A	21-401	SINGLE LEVER HANDLE
B	21-129	CAP & RING
C	23-403	CAM & PACKING
D	26-331	S. S. BALL
E	23-400	SEATS & SPRINGS (2 EACH)
F	20-659	O' RING
G	22-715	SPOUT
H	24-155	AERATOR
I	23-433	SEAT
J	23-172	SPRAY DIVERTER
K	23-402	REPAIR KIT
L	23-436	SPRING

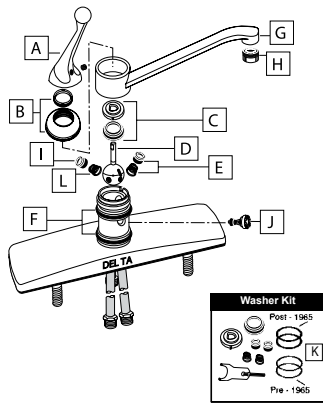

**DELTA**  
FAUCET COMPANY  
**GENUINE PARTS**  
SHOWER

ID.	ITEM #	DESCRIPTION
A	22-241	HOT/COLD INDEX BUTTON
B	21-404	HOT/COLD HANDLES
C	13-408	ESCUTCHEON
D	21-129	CAP & RING
E	23-405	CAM & PACKING
F	26-333	S. S. BALL
G	26-311D	DIVERTER
H	23-400	SEATS & SPRINGS (2 EACH)
I	23-433	SEAT
J	23-436	SPRING

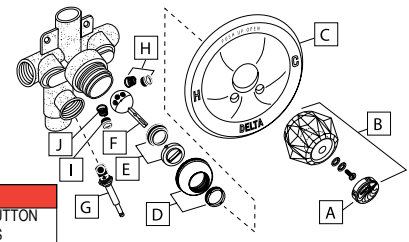

**DELTA**  
FAUCET COMPANY  
**GENUINE PARTS**  
SHOWER

ID.	ITEM #	DESCRIPTION
A	21-404	HOT/COLD HANDLES
B	26-210	HOT/ COLD CARTRIDGE
C	26-311D	DIVERTER
D	23-400	SEATS & SPRINGS (2 EACH)
E	23-433	SEAT
F	23-436	SPRING
G	13-408	ESCUTCHEON

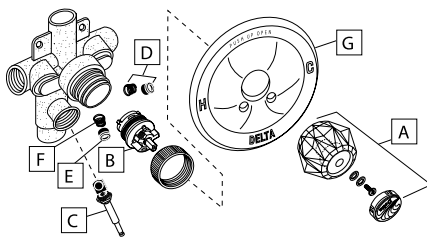

**DELTA**  
FAUCET COMPANY  
**GENUINE PARTS**  
SHOWER

ID.	ITEM #	DESCRIPTION
A	23-312H	HOT INDEX BUTTON
B	23-312C	COLD INDEX BUTTON
C	22-538	HOT/COLD HANDLES
D	26-347	STEM EXTENSION
E	26-437	HOT/COLD CARTRIDGE
F	23-433	SEAT
G	23-400	SEATS & SPRINGS (2 EACH)
H	23-436	SPRING

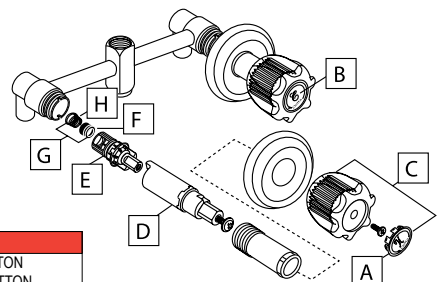

Notes:

**For ELJER SHOWER**

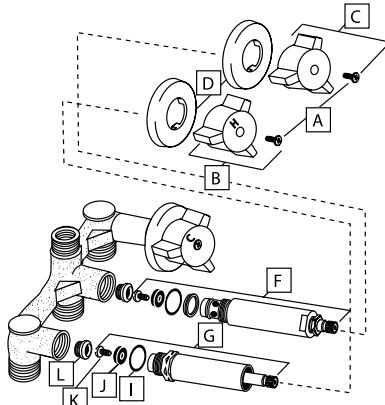

ID	ITEM #	DESCRIPTION
A	20-813	HANDLE SCREW
B	29-559	HOT/COLD HANDLES
C	29-559D	DIVERTER HANDLE
D	23-290	FLANGE
F	28-812D	DIVERTER STEM
G	28-764R	HOT/COLD STEM
I	20-442	CAP GASKET
J	20-733	BIBB WASHER
K	20-241	BIBB SCREW
L	27-452	SEAT

**For ELJER SHOWER**

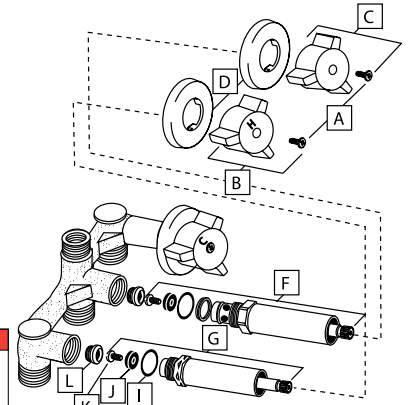

ID	ITEM #	DESCRIPTION
A	20-813	HANDLE SCREW
B	29-559	HOT/COLD HANDLES
C	29-559D	DIVERTER HANDLE
D	23-290	FLANGE
F	28-803D	DIVERTER STEM
G	28-646R	HOT/COLD STEM
I	20-442	CAP GASKET
J	20-733	BIBB WASHER
K	20-241	BIBB SCREW
L	27-452	SEAT

**For GERBER LAVATORY (AND KITCHEN)**

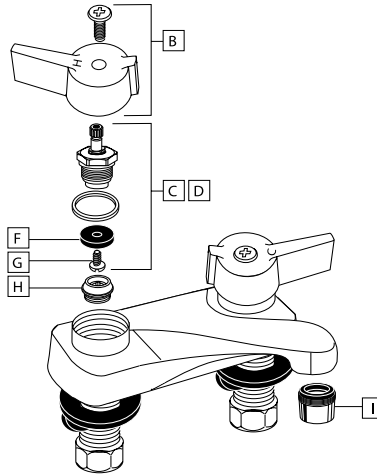

ID	ITEM #	DESCRIPTION
B	29-574	HOT/COLD HANDLES
C	28-160R	RH HOT STEM
D	28-160L	LH COLD STEM
F	20-733	BIBB WASHER
G	20-243	BIBB SCREW
H	27-386	SEAT
I	23-144	AERATOR

**For GERBER LAVATORY (AND KITCHEN)**

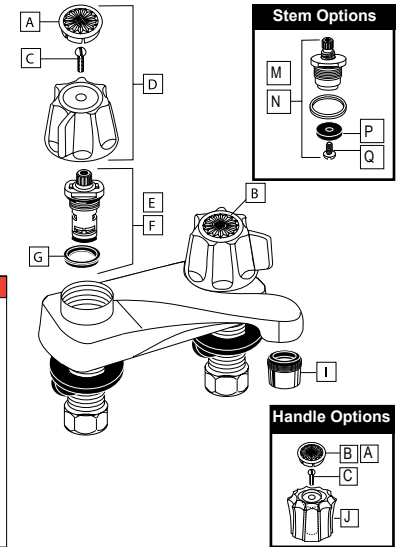

ID	ITEM #	DESCRIPTION
A	22-063H	HOT INDEX BUTTON
B	22-063C	COLD INDEX BUTTON
C	20-811	HANDLE SCREW
D	29-576	HOT/COLD HANDLES
E	26-219	HOT CARTRIDGE
F	26-220	COLD CARTRIDGE
G	21-166	CARTRIDGE WASHER
I	23-144	AERATOR
J	22-577	HOT/COLD HANDLES
M	28-059R	RH HOT STEM
N	28-059L	LH COLD STEM
P	20-733	BIBB WASHER
Q	20-243	BIBB SCREW

**For GERBER SHOWER**

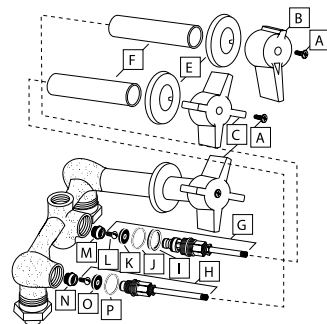

ID	ITEM #	DESCRIPTION
A	20-807	HANDLE SCREW
B	29-572D	DIVERTER HANDLE
C	29-572	HOT AND COLD HANDLE PAIR
E	23-299	FLANGE BODY
F	23-211	SLEEVE
G	28-723D	DIVERTER STEM
H	28-695R	HOT/COLD STEM
I	20-357	CARTRIDGE WASHER
J	20-434	CAP GASKET
K	20-734	BIBB WASHER
L	20-248	BIBB SCREW
M	27-386	SEAT
N	20-430	CAP GASKET
O	20-248	BIBB SCREW
P	20-734	BIBB WASHER

**For GERBER SHOWER**

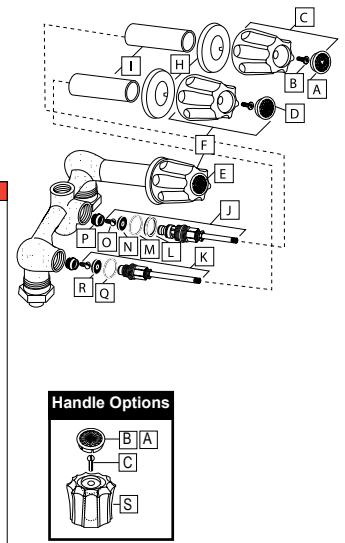

ID	ITEM #	DESCRIPTION
A	22-063D	DIVERTER BUTTON
B	20-811	HANDLE SCREW
C	29-573D	DIVERTER HANDLE
D	22-063H	HOT BUTTON
E	22-063C	COLD BUTTON
F	29-573	HOT AND COLD HANDLE PAIR
H	23-299	FLANGE
I	23-211	SLEEVE
J	28-723D	DIVERTER STEM
K	28-695R	HOT/COLD STEM
L	20-357	CARTRIDGE WASHER
M	20-434	CAP GASKET
N	20-734	BIBB WASHER
O	20-248	BIBB SCREW
P	27-386	SEAT
Q	20-430	CAP GASKET
R	20-734	BIBB WASHER
S	22-578	HOT/COLD HANDLES

Notes:



**For HARCRAFT LAVATORY (AND KITCHEN)**

ID	ITEM #	DESCRIPTION
A	29-309	HOT/COLD HANDLES
B	28-080R	RH HOT/COLD STEM
C	27-396	SEAT
E	20-733	BIBB WASHER
F	20-243	BIBB SCREW
G	23-144	AERATOR

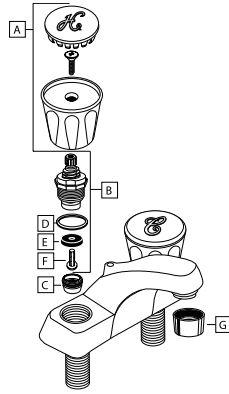

**For INDIANA BRASS SHOWER**

ID	ITEM #	DESCRIPTION
A	29-596D	DIVERTER HANDLE
B	20-807	HANDLE SCREW
C	29-596	HOT AND COLD HANDLE PAIRS
E	23-290	FLANGE
F	23-271	SLEEVE
G	28-582D	DIVERTER STEM
H	28-580R/L	HOT/COLD STEM
I	20-616	CAP GASKET
J	20-733	BIBB WASHER
K	20-241	BIBB SCREW
L	27-362	SEAT
M	20-215	O'RING
N	20-733	BIBB WASHER
O	20-241	BIBB SCREW
P	27-509	SEAT

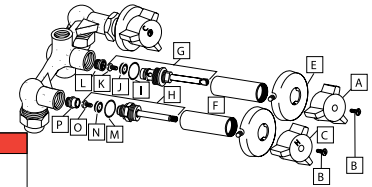

**For KOHLER LAVATORY (KITCHEN, TUB & SHOWER TOO)**

ID	ITEM #	DESCRIPTION
A	20-818	HANDLE SCREW
B	25-500	BONNET NUT
C	20-200	O'RING
D	20-206	O'RING
E	26-584	HOT CELCON PLUNGER
F	26-586	HOT BRASS PLUNGER
G	26-583	COLD CELCON PLUNGER
H	26-585	COLD BRASS PLUNGER
J	20-241	BIBB SCREW
K	26-582	BARREL
L	27-394	SEAT
M	28-469L	HOT STEM (CELCON PLUNGER)
N	28-460L	HOT STEM (BRASS PLUNGER)
O	28-469R	COLD STEM (CELCON PLUNGER)
P	28-460R	COLD STEM (BRASS PLUNGER)
Q	23-144	AERATOR
R	29-612	HANDLES PAIR

**TRITON**

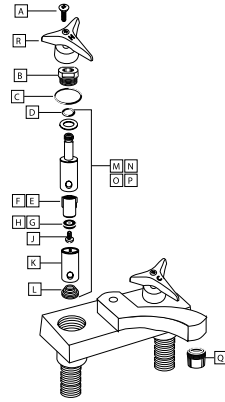

**For KOHLER LAVATORY (AND KITCHEN)**

ID	ITEM #	DESCRIPTION
A	22-035H	HOT BUTTON
B	22-035C	COLD BUTTON
C	20-818	HANDLE SCREW
D	29-619	HOT/COLD HANDLE PAIR
E	28-014R	RH HOT STEM
F	28-014L	LH COLD STEM
G	20-442	CAP GASKET
H	20-731	BIBB WASHER
I	20-241	BIBB SCREW
J	27-306	SEAT
K	23-140	AERATOR

**TREND**

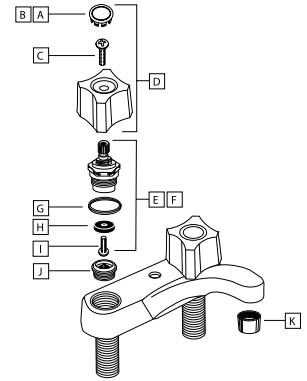

**For KOHLER SHOWER**

ID	ITEM #	DESCRIPTION
A	22-035H	HOT BUTTON
B	22-035C	COLD BUTTON
C	20-294	HANDLE SCREW
D	29-870	HOT/COLD HANDLE PAIR
E	23-268	SLEEVE
F	23-277	SHOWER FLANGE
G	28-632D	DIVERTER STEM
H	28-634R	HOT STEM
I	28-634L	COLD STEM
K	20-731	BIBB WASHER
L	20-241	BIBB SCREW
M	27-306	SEAT

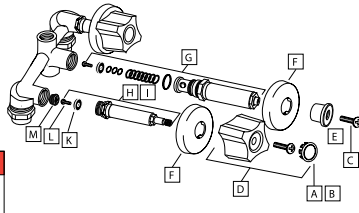

**For MOEN LAVATORY**

ID	ITEM #	DESCRIPTION
A	21-656	HOT/COLD HANDLES
C	26-905	CARTRIDGE CLIP
D	26-901	HOT/COLD CARTRIDGE
E	22-633	CARTRIDGE REBUILD KIT
F	23-144	AERATOR
H	26-900	HOT/COLD STEM
I	22-633	CARTRIDGE REBUILD KIT
J	23-264	SLEEVE
K	21-650	ACRYLIC HANDLE

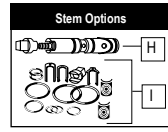
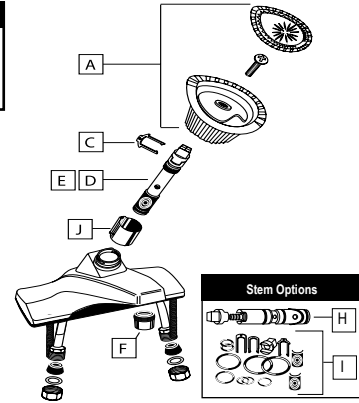
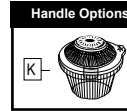

**For MOEN SHOWER**

ID	ITEM #	DESCRIPTION
A	21-653	HOT/COLD HANDLE
C	23-264	FLANGE TUBE
D	13-414	FLANGE
E	26-901	HOT/COLD CARTRIDGE
G	26-286	BALANCING SPOOL
H	26-905	CARTRIDGE CLIP
J	26-900	HOT/COLD STEM
K	22-633	CARTRIDGE REBUILD KIT
L	21-650	ACRYLIC HANDLE

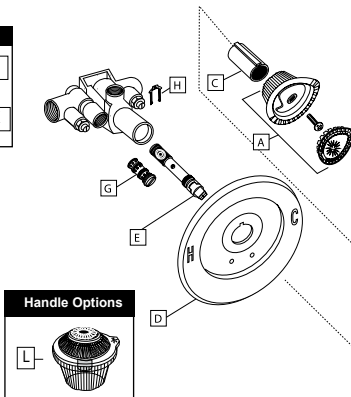
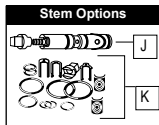

**For MOEN KITCHEN**

ID	ITEM #	DESCRIPTION
A	21-669	HOT/COLD HOUSING
B	26-901	HOT/COLD CARTRIDGE
C	22-633	CARTRIDGE REBUILD KIT
D	20-624	O'RING
E	21-662	HOT/COLD HANDLE
F	23-140	AERATOR
G	23-207	DIVERTER VALVE
H	26-907	CARTRIDGE CLIP
I	26-900	HOT/COLD STEM
J	22-633	CARTRIDGE REBUILD KIT

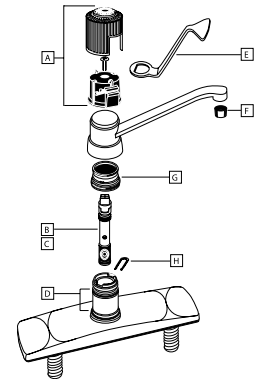
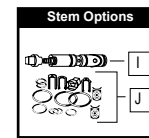

Notes:

### For NIBCO LAVATORY

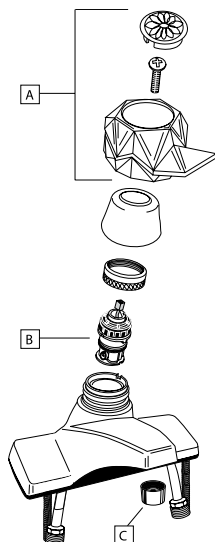

#### 200 & 300 SERIES

ID	ITEM #	DESCRIPTION
A	21-963	HOT/COLD HANDLE
B	26-988	HOT/COLD CARTRIDGE
C	23-140	AERATOR

### For NIBCO LAVATORY (AND KITCHEN)

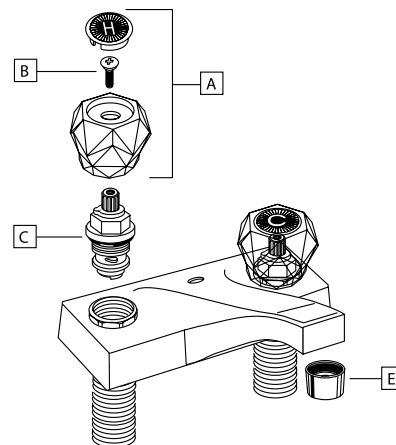

ID	ITEM #	DESCRIPTION
A	22-860	HOT/COLD HANDLES
B	20-291	HANDLE SCREW
C	26-241	HOT/COLD CARTRIDGE
E	23-140	AERATOR

Hole punched for pegboard storage

Reorder Item#

Genuine Delta Parts mean no expensive call backs

Ziplock clear polybag for easy access

Detailed illustration clearly defining kit contents

Barcoding means you'll receive the correct item.!

### For PRICE PFISTER LAVATORY

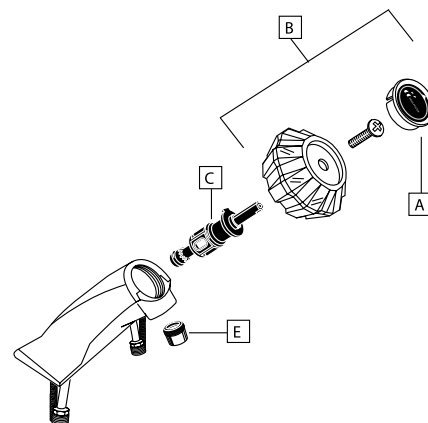

#### AVANTE

ID	ITEM #	DESCRIPTION
A	22-075	HOT/COLD BUTTON
B	21-705	HOT/COLD HANDLE
C	26-230	HOT/COLD CARTRIDGE
E	23-144	AERATOR

### For PRICE PFISTER LAVATORY (AND KITCHEN)

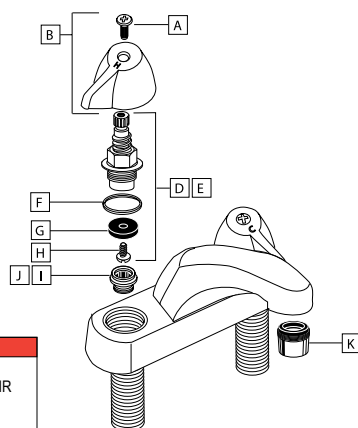

ID	ITEM #	DESCRIPTION
A	20-807	HANDLE SCREW
B	29-697	HOT AND COLD HANDLE PAIR
D	28-185R	RH HOT STEM
E	28-185L	LH COLD STEM
F	20-442	CAP GASKET
G	20-731	BIBB WASHER
H	20-243	BIBB SCREW
I	27-340	SEAT
J	27-341	MONEL SEAT
K	23-144	AERATOR

### For PRICE PFISTER SINK

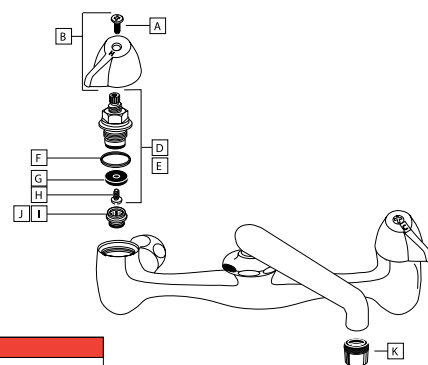

ID	ITEM #	DESCRIPTION
A	20-807	HANDLE SCREW
B	29-698	HOT AND COLD HANDLE PAIR
D	28-035R	RH HOT STEM
E	28-035L	LH COLD STEM
F	20-442	CAP GASKET
G	20-731	BIBB WASHER
H	20-243	BIBB SCREW
I	27-340	SEAT
J	27-341	MONEL SEAT
K	23-144	AERATOR

Notes:

**For PRICE PFISTER**

**KITCHEN**

**33 SERIES**

ID	ITEM #	DESCRIPTION
A	22-267H	HOT BUTTON
B	22-267C	COLD BUTTON
C	20-811	HANDLE SCREW
D	29-700	HOT/COLD HANDLES
E	28-155R	HOT/COLD STEM
F	20-442	CAP GASKET
G	20-731	BIBB WASHER
H	22-763	SPOUT
I	23-141	AERATOR
J	20-248	BIBB SCREW
K	27-340	SEAT
L	27-341	MONEL SEAT
M	20-214	O'RING
N	22-604H	HOT BUTTON
O	22-604C	COLD BUTTON
P	20-811	HANDLE SCREW
R	28-280L	HOT/COLD STEM
S	27-336	SEAT CAGE
T	27-337	CAGE WASHER
U	26-288L	HOT STEM
V	26-288R	COLD STEM
X	21-186	CARTRIDGE WASHER
W	22-783	HOT/COLD HANDLES

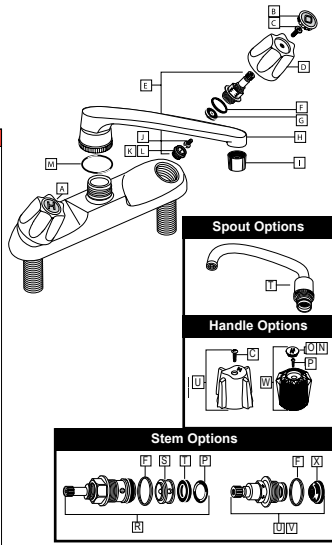

**For PRICE PFISTER**

**SHOWER**

ID	ITEM #	DESCRIPTION
A	20-811	HANDLE SCREW
B	22-669H	HOT BUTTON
C	22-669C	COLD BUTTON
D	29-690	HOT/COLD DIVERTER HANDLE
E	23-199	FLANGE
F	23-285	SLEEVE
G	28-675D	DIVERTER STEM
I	20-430	DIVERTER CAP GASKET
J	20-442	HOT/COLD CAP GASKET
K	20-737	BIBB WASHER
L	20-243	BIBB SCREW
M	27-338	SEAT
N	28-656R	HOT/COLD STEM

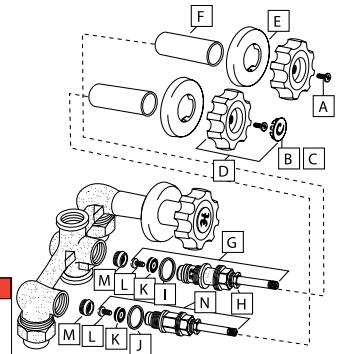

**For PRICE PFISTER**

**SHOWER**

ID	ITEM #	DESCRIPTION
A	23-497	SHOWER FLANGE NUT
B	23-797	POL. BRASS DIVERTER FLANGE
C	23-195	CHROME DIVERTER FLANGE
D	23-280	FLANGE NIPPLE
E	21-617	STEM BUSHING
F	28-823D	DIVERTER STEM
G	20-442	DIVERTER CAP GASKET
H	28-659R	HOT/COLD STEM
I	20-737	BIBB WASHER
J	20-243	BIBB SCREW
K	20-430	HOT/COLD GASKET
L	27-338	SEAT

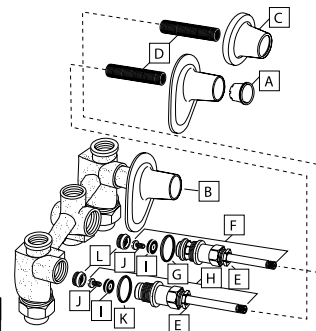

**For PRICE PFISTER**

**SHOWER**

ID	ITEM #	DESCRIPTION
A	22-604H	HOT BUTTON
B	22-604C	COLD BUTTON
D	20-811	HANDLE SCREW
E	22-787	HOT/COLD HANDLE PAIR
F	22-267H	HOT BUTTON
G	22-267C	COLD BUTTON
H	22-267D	DIVERTER BUTTON
I	20-811	HANDLE SCREW
J	29-702	HOT/COLD HANDLES
K	29-702D	HOT/COLD DIVERTER HANDLE
L	29-852	HOT/COLD HANDLE PAIR
M	29-852D	DIVERTER HANDLE
N	22-068H	HOT BUTTON
O	22-068C	COLD BUTTON
P	22-068D	DIVERTER BUTTON
Q	22-783	HOT/COLD HANDLE
R	22-693	HOT/COLD HANDLE



**For SAYCO**

**LAVATORY (AND KITCHEN)**

ID	ITEM #	DESCRIPTION
A	22-048H	HOT BUTTON
B	22-048C	COLD BUTTON
C	20-294	HANDLE SCREW
D	29-747	HOT/COLD HANDLE PAIR
E	28-020R	HOT STEM
F	28-020L	COLD STEM
G	20-617	O'RING
H	20-731	BIBB WASHER
I	20-241	BIBB SCREW
J	27-372	SEAT
K	27-373	SEAT
L	23-140	AERATOR
Q	22-758	HOT AND COLD HANDLE PAIR

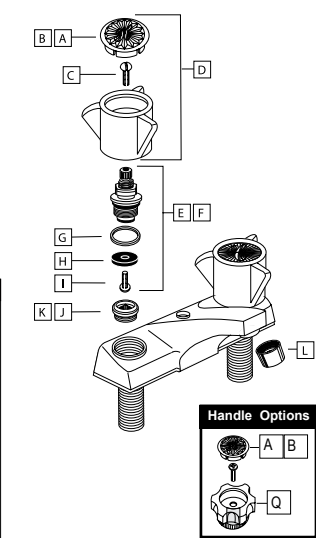

**For SAYCO**

**SHOWER**

ID	ITEM #	DESCRIPTION
A	22-048D	DIVERTER BUTTON
B	22-048H	HOT BUTTON
C	22-048C	COLD BUTTON
D	20-294	HANDLE SCREW
E	29-748	HOT /COLD HANDLES
F	29-748D	DIVERTER HANDLE
G	23-212	FLANGE
I	23-214	SLEEVE
J	28-738D	DIVERTER STEM
K	28-637R	HOT/COLD STEM
L	20-612	O'RING
M	20-731	BIBB WASHER
N	20-241	BIBB SCREW
O	27-372	SEAT
P	27-373	SEAT

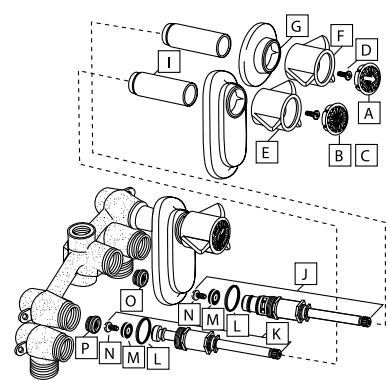

Notes:



**For  
STERLING**  
KITCHEN (AND LAVATORY)

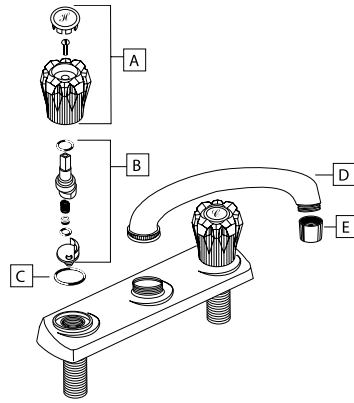

ID.	ITEM #	DESCRIPTION
A	22-790	HOT/COLD HANDLES
B	26-239	HOT/COLD CARTRIDGE
C	20-200	O'RING
D	22-700	SPOUT
E	23-140	AERATOR

**For  
STERLING**  
KITCHEN (AND LAVATORY)

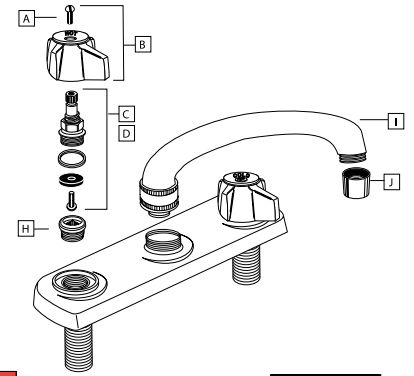

ID.	ITEM #	DESCRIPTION
A	20-803	HANDLE SCREW
B	29-787	HOT/COLD HANDLES
C	28-205R	HOT STEM
D	28-205L	COLD STEM
H	27-342	SEAT
I	22-705	SPOUT
J	23-140	AERATOR
K	29-786	HOT/COLD HANDLES



**For  
STERLING**  
SHOWER

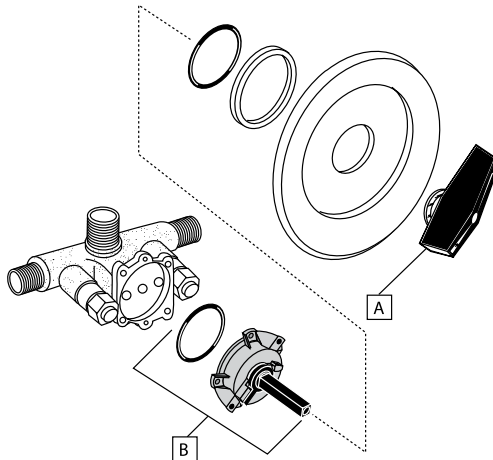

ID.	ITEM #	DESCRIPTION
A	21-761	HOT/COLD HANDLE
B	26-200	HOT/COLD CARTRIDGE

**For  
STERLING**  
SHOWER

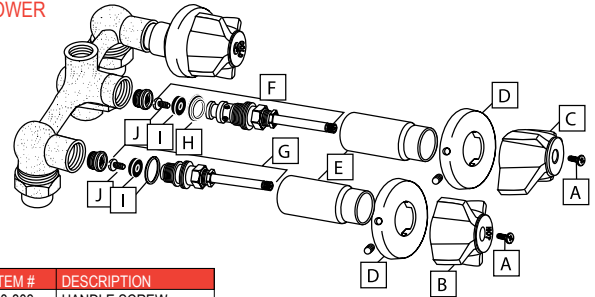

ID.	ITEM #	DESCRIPTION
A	20-803	HANDLE SCREW
B	29-788	HOT/COLD HANDLES
C	29-788D	DIVERTER HANDLE
D	23-199	FLANGE
E	23-996	SLEEVE
F	28-731D	DIVERTER STEM
G	28-715R	HOT/COLD STEM
H	20-357	DIVERTER WASHER
I	20-733	BIBB WASHER
J	20-243	BIBB SCREW

**For  
SYMMONS**  
SHOWER

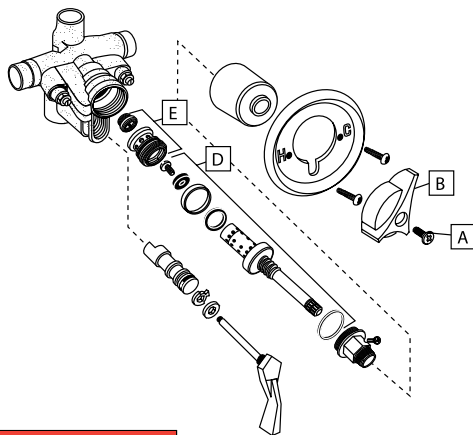

ID.	ITEM #	DESCRIPTION
A	20-813	HANDLE SCREW
B	21-305	TEMPERATURE CONTROL HANDLE
D	26-969	SPINDLE ASSEMBLY
E	22-967	HOT/COLD SEAT KITS

**CONSOLIDATE YOUR TRUCK INVENTORY  
BY STOCKING OUR REBUILD KITS.**

**WE CAN "MAKE TO ORDER" ANY  
KIT YOU NEED TO HELP RUN  
YOUR BUSINESS BETTER.**

**WE'VE FOCUSED ON PLUMBING REPAIR FOR  
A LONG TIME. OUR SELECTION CONTINUES  
TO GROW FROM CUSTOMER REQUESTS.  
THANK YOU!**

Notes:

**For UNION BRASS**

LAVATORY (AND KITCHEN)

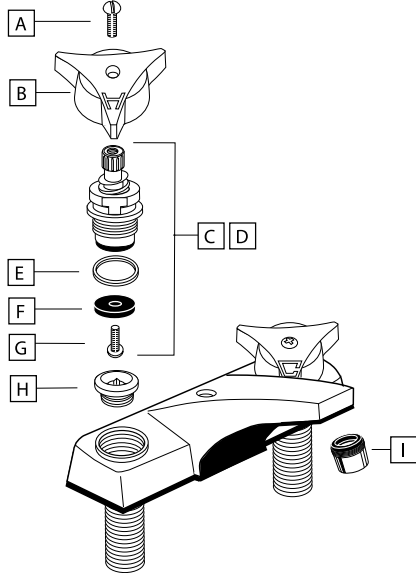

ID	ITEM #	DESCRIPTION
A	20-813	HANDLE SCREW
B	29-528	HOT/COLD HANDLES
C	28-025R	HOT STEM
D	28-025L	COLD STEM
E	20-442	CAP GASKET
F	20-733	BIBB WASHER
G	20-241	BIBB SCREW
H	27-324	SEAT
I	23-144	AERATOR
J	29-524	HOT/COLD HANDLES

**For UNION BRASS**

SHOWER

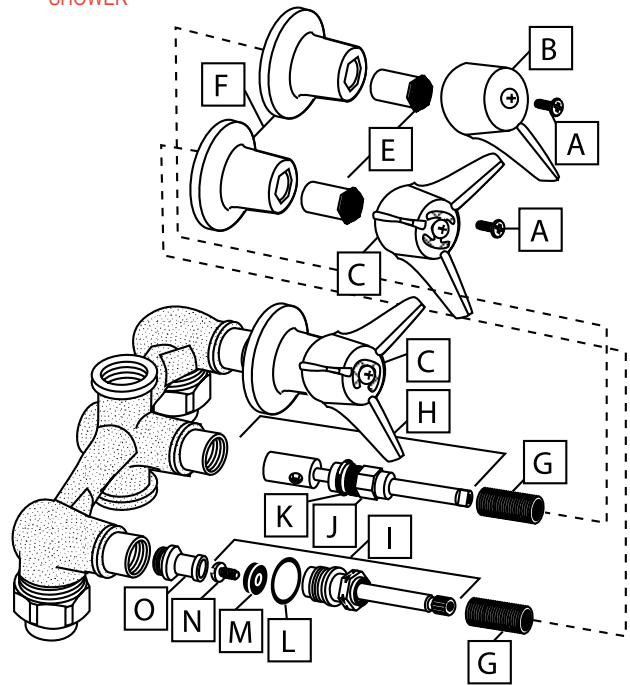

ID	ITEM #	DESCRIPTION
A	20-821	HANDLE SCREW
B	29-829D	DIVERTER HANDLE
C	29-829	HOT/COLD HANDLES
D	29-529	HOT/COLD HANDLES
E	23-998	SLEEVE
F	23-990	ESCUTCHEON
G	23-994	NIPPLE
H	28-553D	DIVERTER STEM
I	28-550R/L	HOT/COLD STEM
J	20-616	O'RING
K	20-210	O'RING
L	20-442	CAP GASKET
M	20-733	BIBB WASHER
N	20-241	BIBB SCREW
O	27-489	SEAT

**For VALLEY**

LAVATORY (KITCHEN, TUB & SHOWER)

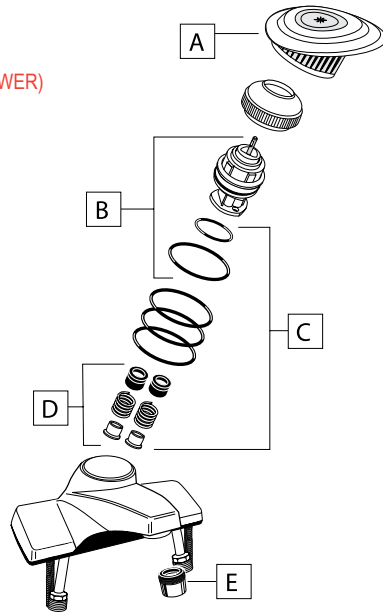

ID	ITEM #	OEM#	DESCRIPTION
A	21-492	V6679	HOT/COLD HANDLE
B	26-926	V6680	HOT/COLD CARTRIDGE
C	21-193	V1001	GASKET KIT
D	21-257	V7059	SEAT KIT
E	23-144	V3309	AERATOR
F	21-490	V1165	HOT/COLD HANDLE

**For VALLEY**

LAVATORY (AND KITCHEN)

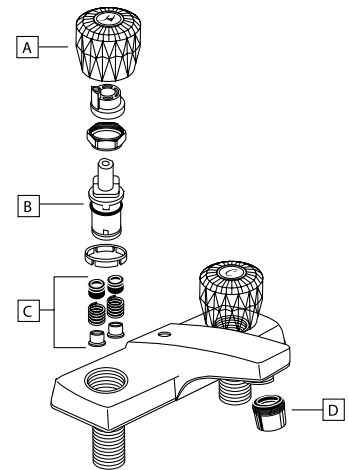

ID	ITEM #	DESCRIPTION
A	22-846	HOT/COLD HANDLE PAIR
B	26-552	HOT/COLD CARTRIDGE
C	21-257	SEAT KIT
D	23-144	AERATOR

Notes: